

# CORPORATE CURRICULUM VITAE





**You can reach us at:**

US Office:  
5161 San Felipe Street,  
Suite 320-5434Houstons,  
TX 77056

---

UK Office:  
40 Penton House,  
Hartslock Drive London,  
United Kingdom.  
Postcode: Se2 9UZ

---

Nigeria Office:  
47 Trans Amadi Industrial Layout  
Port Harcourt, Rivers State  
Nigeria

---

+234 (0) 8183600290  
+234 (0) 8026368505

---

egobaseglobal@gmail.com  
info@egobaseglobal.com

---

www.egobaseglobal.com

# Content Page

1

**Introduction**

2

**Core Competencies**

3

**Company's Experience**

4

**Team & Personnel**

5

**Technical Expertise**

6

**Health, Safety, and Environmental Practices**

7

**Certifications & Accreditations**

8

**Client Testimonials & References**

9

**Innovations & Technologies**

10

**Project Portfolio**

11

**Our Clients & Partners**

12

**Contact Information**



# **INTRODUCTION**

Welcome to Egobase Global Limited, your trusted partner in construction excellence. Since our establishment in 2015, Egobase Global Limited has been a cornerstone in the construction industry, dedicated to delivering unparalleled quality and innovation.

### **Our Mission:**

At Egobase Global Limited, our mission is to reach the hallmark of excellence in the construction niche. We are committed to shaping the future by changing the narratives of service delivery and customers satisfaction in the industry.

### **What Sets Us Apart:**

- With a track record of products and services optimization within the domain, we stand out as leaders in the general civil and engineering construction activities.
- Our commitment to highlighting details being the best industry-leading practices, our safety standards, and sustainability initiatives, we ensures that every project we undertake is of the highest caliber.

### **Our Services:**

Egobase Global Limited specializes in as-built design conformity, providing essentially impeccable construction solutions and result-driven services to our clients which aids their consistent productivity. From concept to completion, our team is dedicated to bringing visions to life.

### **Commitment to Quality:**

Quality is the foundation of our operations. Egobase Global Limited adheres to the most stringent standards in the construction industry. Our team is unwavering in ensuring standards are upheld judiciously and that specific aspects of quality, such as precision, durability, or craftsmanship are attained.

### **Client-Centric Approach:**

At Egobase Global Limited, we prioritize building enduring relationships with our clients. Our client-centric approach involves clear and concise information dissemination, ultimate clients satisfaction, transparent communication ethics, and clients' collaboration enhancement throughout every phase of the construction process.

**Safety and Sustainability:**

We not only build structures but also contribute to a safer and more sustainable future. Egobase Global Limited is dedicated to maintain in totality all industry safety protocols and crafts sustainability practices to minimize our environmental impact.

**Looking to the Future:**

As Egobase Global Limited continues to grow, we remain focused on creating eco-friendly construct concepts, human capacity and sustainable developments. We are enthusiastic about the opportunities ahead and are dedicated to enhance business growth relationships with industry experts, generate developmental initiatives which shall add value to the construction industry.

Thank you for considering Egobase Global Limited. We invite you to explore our profile further and discover how we can bring your construction visions to reality with precision, expertise, and a commitment to excellence.





# **CORE COMPETENCIES**

# Core Competencies



At Egobase Global Limited, our core competencies form the bedrock of our success in the construction industry. These distinctive capabilities set us apart, enabling us to deliver exceptional value to our clients and establish a prominent presence in the market.

## 1. Technical Expertise:

Our team at Egobase Global Limited possesses unparalleled technical expertise in various construction disciplines. From conceptualization to execution, our professionals bring in-depth knowledge and experience to every project, ensuring precision and excellence.

## 2. Innovative Solutions:

Innovation is at the heart of our operations. Egobase Global Limited is known for pioneering construction solutions that not only meet but exceed industry standards. Our commitment to continuous improvement and creative problem-solving is a cornerstone of our success.

## 3. Project Management Excellence:

Efficient project management is one of our key competencies. We excel in coordinating complex construction projects, ensuring timelines are met, resources are optimized, and quality is maintained throughout every phase of development.

## 4. Safety Protocols and Compliance:

Egobase Global Limited places the highest priority on safety. Our robust safety protocols and compliance measures ensure a secure working environment for our team and all stakeholders involved in our projects.



# Core Competencies



## 5. Sustainable Practices:

Environmental responsibility is woven into our corporate DNA. Egobase Global Limited is dedicated to integrating sustainable practices into our construction processes, contributing to a greener future while meeting the evolving demands of environmentally conscious clients.

## 6. Client-Centric Approach:

Building lasting relationships with our clients is not just a goal; it's a core competency. Our client-centric approach involves active collaboration, transparent communication, and a commitment to understanding and meeting the unique needs and goals of every client.

## 7. Quality Craftsmanship:

Egobase Global Limited stands for unparalleled craftsmanship. From the selection of materials to the finishing touches, we ensure that each project reflects the highest standards of quality. Our dedication to craftsmanship sets us apart in the competitive construction landscape.

## 8. Adaptability and Flexibility:

The construction industry is dynamic, and at Egobase Global Limited, we thrive on adaptability. Our ability to flexibly respond to changing project requirements and market conditions is a testament to our resilience and forward-thinking approach.

As we continue to evolve and grow, these core competencies remain the foundation upon which Egobase Global Limited builds its legacy in the construction industry. We invite you to experience the difference that our expertise, innovation, and commitment to excellence can make in bringing your construction visions to reality.



# **COMPANY'S EXPERIENCE**

# Company's Experiences

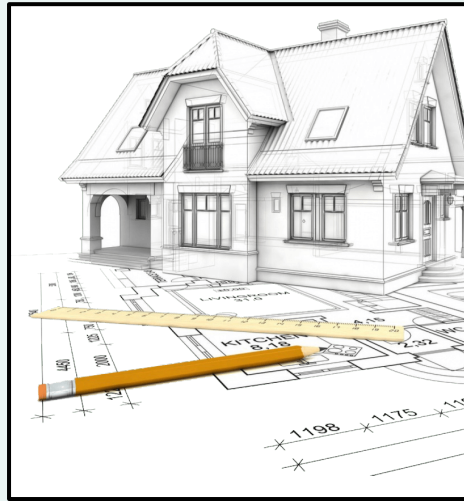

## Architectural Designs

As an indigenous and a leading construction company since 2015, we have cultivated a rich experience in architectural design, consistently delivering projects that blend innovation with functionality.

Renowned for our expertise, Egobase Global has successfully translated conceptual designs into stunning and distinctive structures, reflecting a commitment to both creativity and precision.

Our portfolio showcases a dedication to delivering aesthetically pleasing constructions that meet and exceed client expectations.

With a focus on architectural excellence, Egobase Global Limited stands as a beacon of innovation in the construction industry.

## Road Construction

Mobilizing cutting-edge engineering methodologies, Egobase Global Limited stands at the forefront of road construction, epitomizing excellence in infrastructure development.

Leveraging advanced geotechnical analysis, precision grading, and robust subgrade stabilization techniques, our company consistently delivers roads that endure the test of time. With a commitment to sustainable construction practices, we integrate eco-friendly materials and innovative pavement designs, ensuring longevity and minimizing environmental impact.

We are your trusted partner in crafting thoroughfares that seamlessly combine structural resilience, traffic efficiency, and aesthetic integration for a transformative urban landscape.

# Company's Experiences



## Bridge Construction

Egobase Global Limited is an industry trailblazer in bridge construction, elevating infrastructure standards through avant-garde engineering and design. Our expertise spans intricate structural analysis, utilizing state-of-the-art materials such as high-strength steel and advanced concrete formulations for unparalleled load-bearing capacity.

Employing cutting-edge construction techniques like balanced cantilever and segmental construction, we consistently deliver iconic bridges that transcend architectural boundaries. With an unwavering commitment to safety, our projects integrate intelligent structural health monitoring systems, ensuring the longevity and integrity of our bridges.

Egobase Global Limited is your steadfast partner in creating monumental spans that not only defy engineering challenges but also redefine the skyline with elegance and innovation.

## Engineering Services

We are a pioneering force in engineering services, where precision meets innovation to forge the future of infrastructure. Specializing in a comprehensive spectrum of engineering disciplines, from civil and structural to mechanical and electrical, we bring unique expertise to every project we handle.

Our multidisciplinary approach integrates cutting-edge technologies, such as Building Information Modeling (BIM) and advanced simulation tools, ensuring meticulous planning and flawless execution. Egobase Global is dedicated to sustainable engineering solutions, emphasizing energy efficiency, environmental stewardship, and resilient infrastructure that withstands the test of time.

With a commitment to excellence, we propel engineering services into a realm where creativity converges with technical mastery, setting new standards for transformative and enduring solutions.



# **TEAM & PERSONNEL**



## Meet Our Team



**Eminence Asuru**  
Head, Legal Services

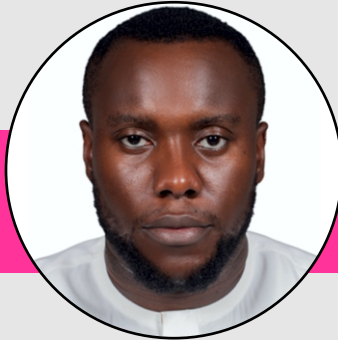

**Joseph Beke**  
CHAIRMAN/CEO



**Aloicious Joshua**  
Senior Project Architect



**Mfon Ikpima**  
Project Consultant

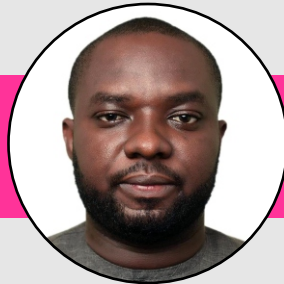

**Oladele Sampson**  
Sustainability Manager

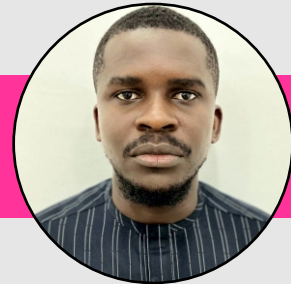

**Bright Abraham**  
Construction Engineer



**Mitaire Wanogho**  
Logistics and Transportation



**Rowland Handsome**  
CLO

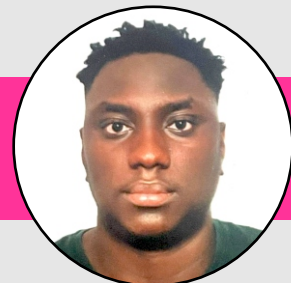

**Yinebary Wilcox**  
Project Architect



**TECHNICAL  
EXPERTISE**

# Technical Expertise

We do exploits in  
Architectural  
Designs and Building  
Projects.



## **Advanced Technologies and Innovation:**

Embracing cutting-edge technologies sets us apart. We leverage Building Information Modeling (BIM), drones, remote sensing, and other innovative tools to enhance project efficiency, accuracy, and collaboration.



# Technical Expertise

When road construction is involved, no other company does it better than we do.



## Construction Management:

Our skilled construction management professionals oversee every aspect of project execution, from planning to completion. We excel in resource allocation, scheduling, procurement, and on-site coordination, ensuring projects are delivered on time and within budget.

# Technical Expertise

Our team of civil engineers are very friendly and well seasoned.



## **Environmental Impact Assessments:**

We have a proven track record of conducting comprehensive environmental impact assessments (EIAs) for projects in sensitive areas. Our team evaluates potential impacts, implements mitigation measures, and ensures adherence to environmental regulations.



**HEALTH,  
SAFETY  
&  
ENVIRON-  
MENTAL  
PRACTICES**

# Health, Safety & Environmental Practices

## Emergency Response Preparedness:

We uphold robust plans for emergency response, designed to manage unforeseen events effectively. Our teams undergo thorough training to respond promptly and efficiently to emergencies, minimizing disruptions to project operations and ensuring the safety of all stakeholders.



## Engagement with Communities and Transparent Communication:

Transparent communication is at the core of our approach. We actively engage with local communities, regulatory bodies, and stakeholders, addressing concerns and incorporating feedback into our projects. This fosters a collaborative and mutually beneficial relationship.

## Continuous Improvement and Auditing:

Dedicated to continuous enhancement in health, safety, and environmental performance, we conduct regular audits, assessments, and lessons learned sessions. These activities enable us to pinpoint areas for improvement and implement corrective measures, further elevating the safety and environmental aspects of our projects.

## Recognition and Awards:

Our unwavering commitment to health, safety, and environmental practices has garnered industry recognition and awards. We take pride in our achievements in establishing a safe and sustainable work environment and remain steadfast in upholding these standards in every project we undertake.

## Certifications and Ongoing Training:

Our teams undergo rigorous training and hold pertinent certifications in health, safety, and environmental practices. We stay abreast of the latest regulations, best practices, and technologies, ensuring the highest level of compliance and performance.

# Health, Safety & Environmental Practices



## **Safety Excellence:**

Ensuring safety is our top priority in all aspects of our operations. Our comprehensive safety initiatives are meticulously crafted to safeguard the well-being of our personnel, partners, and the communities where we operate. Adhering to stringent safety protocols, we conduct regular training to proactively identify and address potential hazards, maintaining incident-free operations.

## **Workplace Health and Well-being:**

The health and well-being of our workforce take precedence. Our health programs actively promote both physical and mental wellness, offering access to medical support and resources to ensure our team members stay healthy and maintain peak productivity.

## **Environmental Responsibility:**

Environmental stewardship is a fundamental aspect of our operational philosophy. We implement sustainable practices to minimize our ecological impact, reduce waste, and conserve resources. Our strategies for environmental management not only ensure compliance with regulations but also contribute to the preservation of ecosystems.

## **Compliance with Regulations and Adoption of Best Practices:**

We are unwaveringly committed to surpassing industry regulations and adhering to the highest standards of health, safety, and environmental practices. Our dedicated compliance teams diligently ensure that all projects align with local and international regulations, preventing any adverse impacts on the environment and surrounding communities.

## **Integration of Innovative Safety Technologies:**

We harness state-of-the-art technologies to elevate our safety measures. From real-time monitoring systems to wearable safety devices, we incorporate cutting-edge tools that enable us to identify and mitigate potential risks, providing an additional layer of protection for our personnel and partners.



# **CLIENT'S TESTIMONIALS & REFERENCES**

# Clients's Testimonial



Egobase services are quite extensive and satisfactory. Their staffs are well coordinated and very friendly.

I highly recommend them!



**Mercy Eboh**  
Regional Manager,  
DG Integrated Services

# Clients's Testimonial



Egobase Global Limited has a great deal of services to offer. There posses in depth knowledge in the construction domain.

I would recommend their services anytime!



**Sanusi Ibrahim**  
Sales Manager,  
Obatech Company Ltd.



# PROJECT PORTFOLIO





# Project Portfolio



**Project:**

**FGN/LNG Assisted Project:**  
Sub-Consultant construction of 2nd Mainland Bridge.

**Location:**

Lagos, Nigeria

**Sector:**

Civil Engineering

**Scope:**

Revamp of existing dilapidated bridge, reinforcement and new construct of 2nd wing of the Mainland bridge.



**Highlights:**

- Implemented innovative trenchless construction techniques to minimal environmental impact.
- Successfully navigated regulatory approvals across international borders.
- Completed the project within budget regardless community challenges.

**Project Award Status:**

Sub-Consultancy

# Project Portfolio



## Project:

Architectural Design/Building Development:

Melvina Suites & Hotels

## Location:

Port Harcourt, Nigeria

## Sector:

Civil & Construction Works

## Scope:

Construction of iconic urban design for hospitality and lodge with ultra-modern features for clients.



## Highlights:

- Utilized advance civil construction modalities to enhance clean standard aesthetics and achieving exquisite delivery on time.
- Receive industry recognition for architectural excellence.

## Project Award Status:

Direct





# Project Portfolio



**Project:**

Rivers State Assisted Project  
Engineering Design,  
Construction & Implementation

**Location:**

Port Harcourt, Rivers State.

**Sector:**

Engineering & Construction

**Scope:**

Managed and designed the construction of a new platform in a remote offshore location.



**Highlights:**

Overcame logistical challenges to complete the platform on time and within budget. Implemented state-of-the-art safety systems resulting to zero lost-time incident during construction activities.

**Project Award Status:**

Direct

# Project Portfolio



## Project:

Rivers State Ministry of Transport.

Abalamabie interior roads construction.

## Location:

Bonny Island, Rivers State.

## Sector:

Civil Construction/Engineering Works

## Scope:

Construction of internal community roads and filling of potholes, leveling and curing of existing asphalts to enable ease of reinforcement procedures.

## Highlights:

- Navigated the internal bureaucracy and maintained sustainable relationship with the community stakeholders.
- Contributed to the expansion project leading to developmental sustainability of the region.
- Received award for excellence in project execution by the Rivers State Government.

## Project Award Status:

Direct





**INNOVATION  
&  
TECHNOLOGIES**

# Innovations & Technologies

## **Advanced BIM Integration:**

Snowbell Energy Services Limited has embraced Building Information Modeling (BIM) as a cornerstone of our project design and management processes. This technology enables us to create accurate 3D models that enhance collaboration, streamline coordination, and minimize errors, resulting in smoother project execution.

## **Drone Surveys and Aerial Mapping:**

We utilize drone technology for aerial surveys and mapping of project sites. Drones provide real-time data, precise measurements, and visual insights, enhancing site assessments, progress tracking, and environmental impact assessments.

## **Prefabrication and Modular Construction:**

Snowbell Energy Services Limited is a proponent of prefabrication and modular construction techniques. By assembling components off-site, we reduce construction time, enhance quality control, and minimize disruptions, ultimately leading to accelerated project schedules.

## **Remote Monitoring and Telemetry:**

Our implementation of remote monitoring and telemetry systems allows us to monitor project parameters, equipment performance, and environmental conditions in real time. This proactive approach enhances safety, minimizes downtime, and optimizes resource allocation.

# Innovations & Technologies

## **Smart Construction Management Systems:**

Our adoption of smart construction management systems enables real-time project tracking, resource allocation, and communication. These systems improve efficiency, enhance transparency, and empower stakeholders with up-to-date information.

## **Energy Efficiency Solutions:**

Snowbell Energy Services Limited is dedicated to energy efficiency. We integrate technologies such as smart lighting, HVAC controls, and renewable energy sources to create environmentally responsible and energy-efficient projects.



## **Advanced Materials and Sustainable Practices:**

We leverage innovative materials and sustainable construction practices to reduce environmental impact. Our commitment to eco-friendly solutions, such as recycled materials and low-energy construction methods, contributes to greener projects.



# **OUR CLIENTS & PARTNERS**





## OUR CLIENTS & PARTNERS

### **Clients:**

- SPDC
- Corrida-Aventus Ltd.
- TSKJ
- NLNG
- SNEPCO
- Rivers State Govt.
- FGN

### **Partners:**

- Japhraim Nig. Ltd.
- Chimeagta Oil & Gas Serv. Ltd.
- Snowbell Energy Serv. Ltd.
- Yobygo Nig. Ltd.
- Peaceline Worldwide Ltd.
- Foney Consult Nig. Ltd.



# **CONTACT INFORMATION**



**You can reach us at:**

US Office:  
5161 San Felipe Street,  
Suite 320-5434Houstons,  
TX 77056

UK Office:  
40 Penton House,  
Hartslock Drive London,  
United Kingdom.  
Postcode: Se2 9UZ

Nigeria Office:  
47 Trans Amadi Industrial Layout  
Port Harcourt, Rivers State  
Nigeria

+234 (0) 8183600290  
+234 (0) 8026368505

egobase@gmail.com  
info@egobase.com

www.egobase.com

**Contact us  
for a lasting  
solution to your  
construction  
need!**



# Your Construction Plug

[www.egobaseglobal.com](http://www.egobaseglobal.com)